

LMM-120 SERIES



Features

- Digital signal processor
- 1/3"SONY Super HAD CCD
- Very high resolution more than 500 TV lines
- The smallest miniature camera
- Infrared acceptable



Dimensions

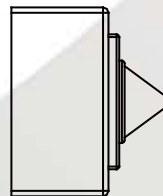
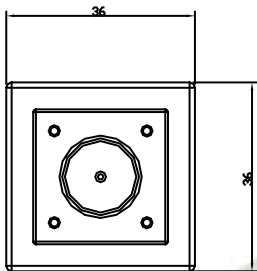
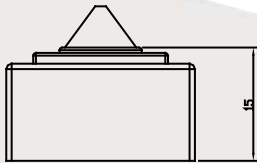

ITEMS	LMM-120 SERIES
SCANNING SYSTEM	2:1 Interlace
ELECTRONIC SHUTTER	Auto
GAIN CONTROL	Auto
BACK LIGHT COMPENSATION	Auto
WHITE BALANCE	Auto
S/N RATIO	More Than 48 dB
GAMMA	0.45
VIDEO OUTPUT	1 VP-P, 75 ohms
STORAGE/OPERATING TEMPERATURE	-30°C ~ +60°C / -10°C ~ +45°C
DIMENSIONS (L*W*H) mm	21×21×19 mm
WEIGHT	180g

Model NO.	Image Sensor	Picture Elements H*V	TVL	Lens Type (mm)	Power Consumption	Sensitivity F:1.2	Chip
LMM-120ASE	1/3" SONY CCD	NTSC:512(H)×492(V) PAL:500(H)×582(V)	420	3.6/3.7mm	DC 12V /80mA	0.1 LUX	NEXT CHIP
LMM-120ASH	1/3" SONY Super HAD CCD	NTSC:768(H)×494(V) PAL:752(H)×582(V)	480	3.6/3.7mm	DC 12V /90mA	0.5 LUX	NEXT CHIP